

# Dr. Grip G-SPEC Oil-based Ballpoint Pen / Use and Care Guide

We developed an easy-to-manuever writing instrument based on ergonomics.

## Oil-based Ballpoint Pen

### 1. Optimal weight balance

Optimal weight balance is achieved by distributing more weight around the center of gravity. This makes it easier to maneuver the pen for minor actions like moving back and forth and rotating while writing. **[Fig.1]**

### 2. The double-layer structure of the grip creates a new gripping sensation.

3. Filled with low-viscosity Acro ink.  
**Darker! Smoother!**  
 (Compared to other PILOT products.)

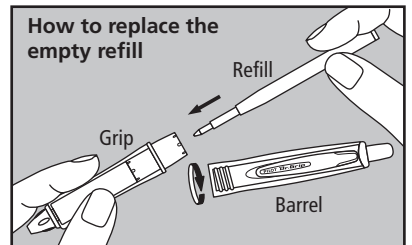
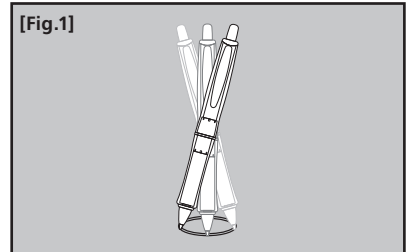
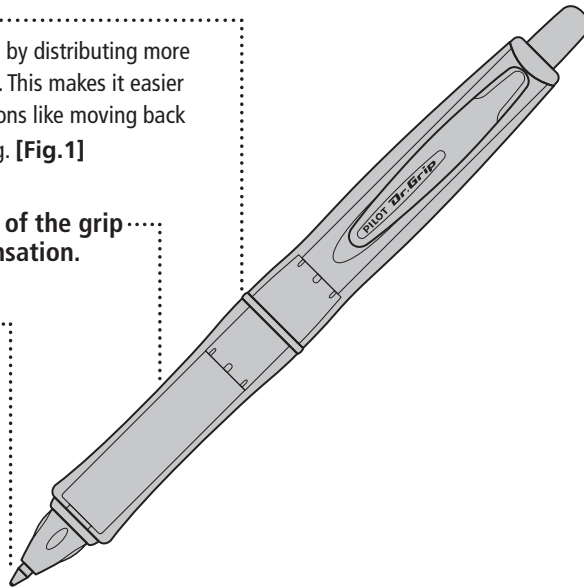

Turn the barrel and insert the refill into the grip side.

## Remarks

- Please do not use this product for any purpose other than writing.
- Keep away from children.
- Avoid writing with the tip of the pen pointing above the horizontal. This may result in ink leakage.
- Avoid severe impacts or violent shaking because the ink may leak.
- Always retract the writing tip after use.
- Note that it may not be possible to remove this ink if it accidentally gets on your clothes.
- Do not store in places exposed to direct sunlight or high temperatures.

The compatible refill for this ballpoint pen is the PILOT **BRFN-10** (Acro-Ink).