

Plunger-Type Fountain Pen / Use and Care Guide

Ink filling method

This product has an ink filling mechanism inside the body, so a spare cartridge or converter cannot be used with it.

- (1) After making sure that the cap is firmly tightened, turn the 70 ml ink bottle (INK-70) upside down. Then, set the bottle back upright. The plastic adapter located in the ink bottle should now be filled with sufficient ink to fill the pen.
- (2) Remove the cap of the fountain pen and hold the nib tip upward. Slowly loosen the screw on the end cap, then pull the end cap all the way out. **[Fig.1]**
- (3) Turn the nib downward and dip it into the ink up to the neck. **[Fig.2]**
- (4) Hold the pen upright and push the knob back in. A vacuum is created, and ink is sucked into the pen as the knob is returned. **[Fig.3]**
- (5) After filling the pen with ink, it's safer to secure the end cap by turning it clockwise.
- (6) Take the pen out of the ink bottle and point the nib upwards and remove any drops of ink with a soft cloth or tissue. Be careful of dripping ink as you take the pen out of the bottle. Care must be taken to wipe off any ink on parts other than the nib or feed tube.

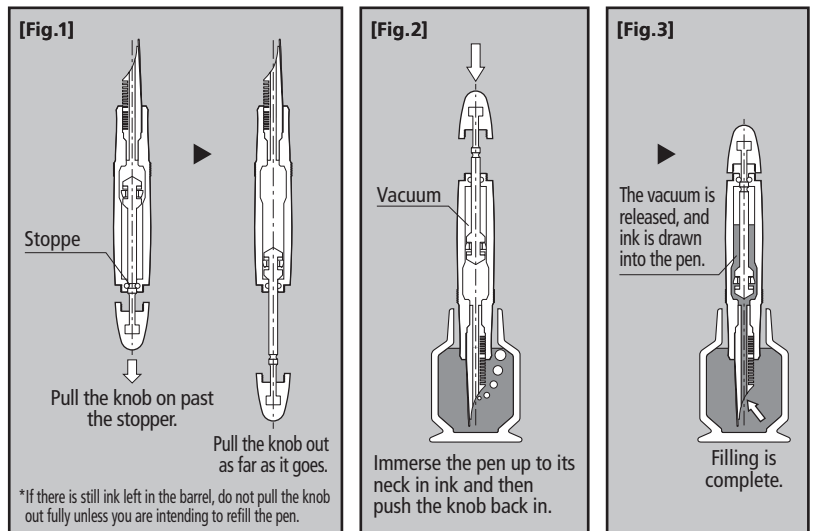

Remarks

The pen features a double-action stopper designed to prevent a messy withdrawal of the end cap section. It provides a certain amount of resistance (stopper) when pulling the end cap. If the end cap is pulled past the stopper while there is still ink in the barrel, it cannot be pushed back in until the ink inside the barrel has been disposed of.

Writing operation

- Remove the cap from the fountain pen. Keeping the nib facing upward, slowly loosen the screw on the end cap. Gently unscrew the end cap until it is free of its threads. The gap should be about 2 mm between the tail end and the metal ring. The pen is now ready for writing. **[Fig.4]**
- When you have finished writing, point the nib upwards and firmly tighten the end cap. **[Fig.5]**

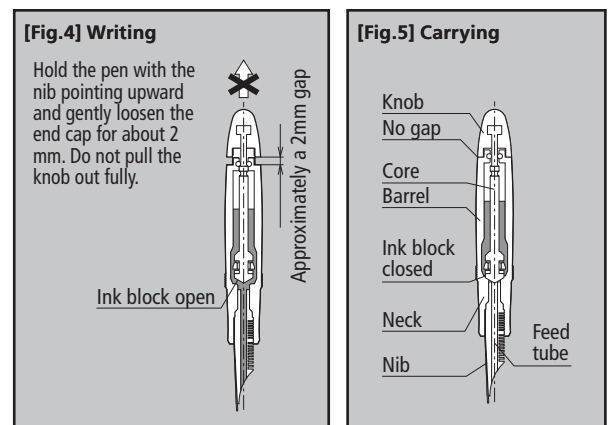

Care and Storage

- Keep the pen out of the reach of children and away from excessive heat, cold, or direct sunlight.
- If the pen is not used regularly, drain the ink from it. Then, clean the inside by filling and draining the pen with clean water several times.
- This pen contains custom-made precision parts. Do not try to repair it yourself.

Remarks

- Do not use except for writing.
- Keep away from children.
- Before changing the ink color, clean the inside by filling and draining the pen with clean water several times.
- Some lubricant has been applied to the mechanical parts and the inside of the barrel. It does not affect the quality of the product even though the pen body may look wet or colored lubricant could accumulate around the piston.
- Do not pull the end cap unless necessary.
- To prevent ink stains, keep the cap and the knob screwed tightly at all times when not writing.
- Changes in air pressure may cause the ink to leak or gush out, so do not use this pen on a plane.
- Do not loosen the end cap too far to the left. Loosening it too much could lead to a malfunction.
- Please take care not to drop the pen as the shock could cause it to malfunction.
- Please be warned that applying chemicals, including solvents, such as alcohol, causes cracks or discoloration.
- Pilot's Tsuwaïro pigment ink for fountain pens is not compatible with this pen.
- Please use PILOT ink for fountain pens. Please note that mixing with other inks or old ink may cause problems.