

# How to enjoy kaküno



Use and Care Guide

## kaküno parts



You also can enjoy the bottled ink with a converter.



## Okay, let's give kaküno a try.

Writing with a fountain pen feels quite different from using other pens and pencils, but once you get the hang of it, you'll be fine.

First, remove the cap and insert the cartridge. Now start using it.

### ① Take off the cap

The first step is to take off the cap. Put your finger in the cavity of the cap and gently pull it off.



### ② Insert the cartridge

Unscrew the neck from the pen body and then evenly and firmly push the cartridge in straight without twisting.



Make sure it's even!



### ③ Wait a short time for the ink to appear

If the ink does not appear after a short time, hold the cartridge between your fingers and push it gently.

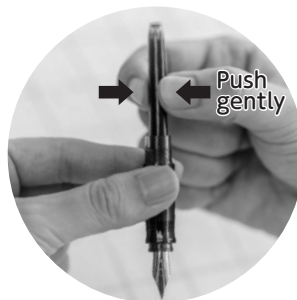

### ④ Try to write

Try writing something with the side with the smiley mark facing up.

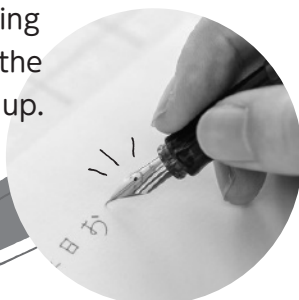

My face is on this side!



## Maintenance

If the ink clogs or dries up, dip the nib of the pen in water.

Glass ▶

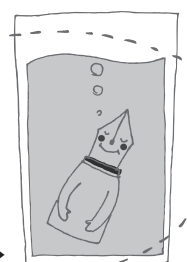

## For adults: How to use the converter (sold separately)

### <Rotation type Converter (CON-40)>

- (1) While holding the neck with the nib pointing up, unscrew the neck from the pen barrel and then insert the converter. **[Fig.1]**
- (2) Rotate the knob of the converter counterclockwise. **[Fig.2]**  
(Handle the pen gently after wipe of ink in the nib with either soft tissue paper or cloth. Since ink may spatter if the nib contains sufficient ink.)
- (3) As shown in Figure 3, dip the nib into the ink vertically. **[Fig.3]**  
\* Be careful not to hit the bottom of the bottle with the nib point to protect the nib.
- (4) Turn the knob of the converter to the right to soak up the ink. **[Fig.3]**

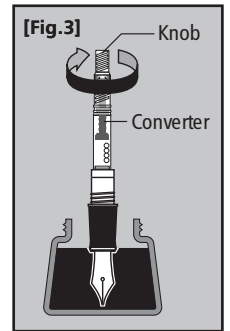
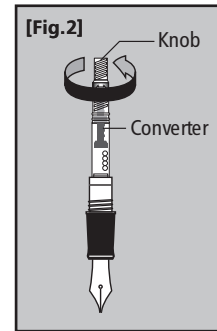
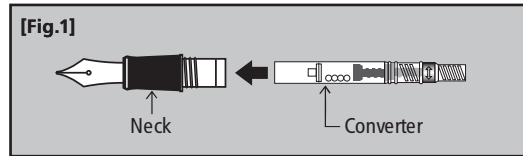

### <Piston type Converter (CON-70N)>

- (1) While holding the neck with the nib pointing up, unscrew the neck from the pen barrel and then insert the converter. **[Fig.4]**  
\* The oil for lubrication may be visible inside, but it does not affect the use of the pen.
- (2) As shown in Figure 5, dip the nib into the ink vertically. **[Fig.5]**  
\* Be careful not to hit the bottom of the bottle with the nib point to protect the nib.
- (3) Press the knob five or six times to fill the ink tank with ink completely. **[Fig.5]**

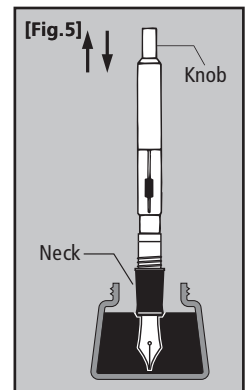
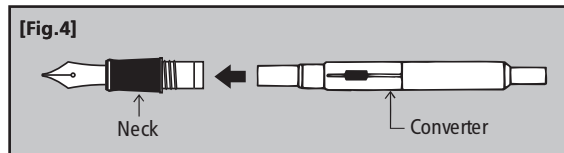

- \* When you want to replace the converter with an ink cartridge, hold the neck of the pen with the nib pointing up and slowly remove the converter by slightly twisting it.  
Any ink remaining in the converter should be washed off with water. Dry the converter completely and store it.
- \* When the bottle has little ink left in it, it can happen that the pen fails to absorb sufficient ink from the bottle. Refill inks from bottles that have a sufficient amount of ink remaining.
- \* Any ink spilled on the neck or nib should be wiped off with either soft tissue paper or cloth before use.

## Remarks

- Use only for writing.
- Children should only use when under adult supervision.
- The nib is extremely sharp. Take care not to point it at others or cause injury to yourself.
- Do not put this product into the mouth. This may cause choking.
- Forcefully removing the cap can send the ink flying, so take care when removing it.
- Always replace the cap firmly after use.
- Avoid placing it in direct sunlight or in high temperatures.
- Take care not to drop the fountain pen because the shock could cause them to malfunction.
- Prevent ink from spilling by pointing the nib upward while replacing the cartridge.
- Please use PILOT ink (cartridge or bottled) for PILOT fountain pens.  
Mixing inks or using old ink may cause problems.