

Fountain Pen / Use and Care Guide

How to fill with ink

Cartridge type

- (1) Unscrew the neck from the pen barrel.
- (2) Remove the empty cartridge from the neck while holding the neck with the nib pointing up.
- (3) Insert a new cartridge. Insert the cartridge straight in. The valve may not open if the cartridge is inserted while twisting it.

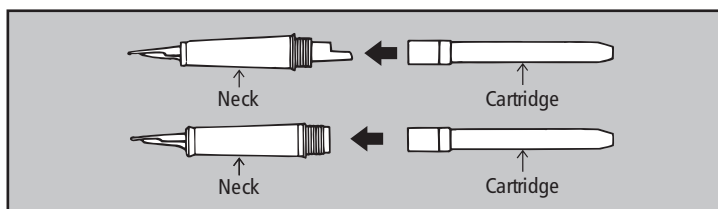

Converter type

<Rotation type Converter (CON-40)>

- (1) While holding the neck with the nib pointing up, unscrew the neck from the pen barrel and then insert the converter. **[Fig.1]**
- (2) Rotate the knob of the converter counterclockwise. **[Fig.2]**
(Handle the pen gently after wipe of ink in the nib with either soft tissue paper or cloth. Ink may spatter if the nib contains sufficient ink.)
- (3) As shown in Figure 3, dip the nib vertically into the ink up to the top of the neck. **[Fig.3]**
* Be careful not to hit the bottom of the bottle with the nib point to protect the nib.
- (4) Fill the converter with ink by turning the converter knob to the right. **[Fig.3]**

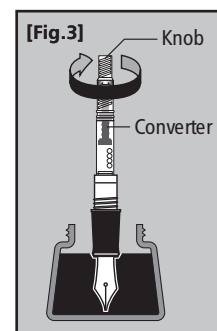
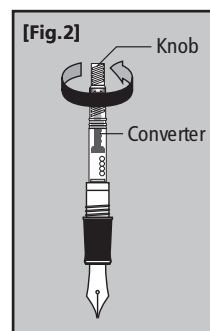
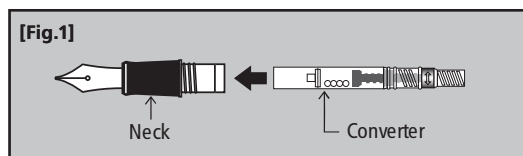

<Piston type Converter (CON-70N)>

- (1) While holding the neck with the nib pointing up, unscrew the neck from the pen barrel and then insert the converter firmly. **[Fig.4]**
* The oil for lubrication may be visible inside, but it does not affect the use of the pen.
- (2) As shown in Figure 5, dip the nib vertically into the ink up to the top of the neck. **[Fig.5]**
* Be careful not to hit the bottom of the bottle with the nib point to protect the nib.
- (3) Press the knob five or six times to fill the ink tank with ink completely. **[Fig.5]**

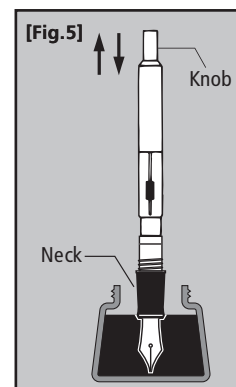
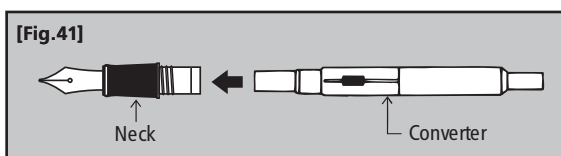

- * When you want to replace the converter with an ink cartridge, hold the neck of the pen with the nib pointing up and slowly remove the converter by slightly twisting it.
Any ink remaining in the converter should be washed off with water. Dry the converter completely and store it.
- * It may be impossible to fill the converter with ink if the amount remaining in the bottle is low. Refill inks from bottles that have a sufficient amount of ink remaining.
- * Any ink on the neck or nib should be wiped off with materials such as soft cloth before use.

Remarks

- Please do not use this product for any purpose other than writing.
- Keep away from children.
- After use always replace the cap firmly.
- When starting to use a fountain pen with an ink cartridge for the first time, gently squeeze the cartridge to start the ink flow.
- Prevent ink from spilling by pointing the nib upward while replacing the cartridge.
- Please take care not to drop these fountain pens since the shock could cause them to malfunction.
- Pilot's Tsuwairo pigment ink for fountain pens cannot be used on lacquerware, including maki-e products.
- Please use PILOT ink (cartridge or bottled) for PILOT fountain pens. Please note that mixing with other inks or old ink may cause problems.