

Capless / Use and Care Guide

Nib Extension and Retraction

<Retractable Type>

- (1) Press the knob down until it clicks into place and the nib comes out.
- (2) Press the knob again until it clicks to retract the nib.

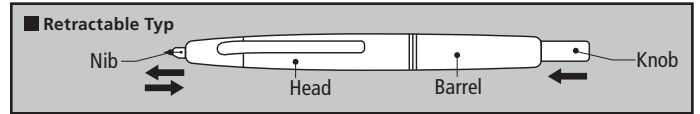

<Revolving Type>

- (1) The nib comes out when the knob is turned in the direction of the arrow.
- (2) The nib retracts when the knob is turned in the other way.

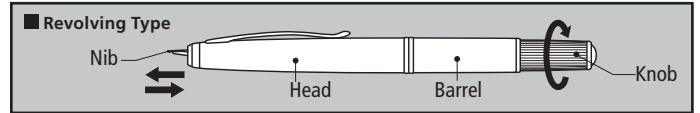

<Click and Twist Type>

- (1) Press the knob and the tip comes out.
- (2) To retract the tip, turn the tail plug in the direction of the arrow.

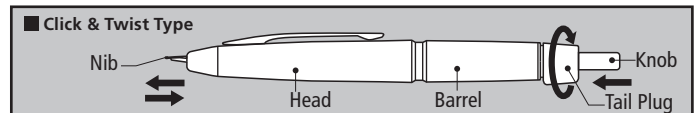

How to fill with ink

■ Cartridge type

- (1) Hold the upper end of the pen pointing slightly upward when the nib is retracted and rotate the barrel counterclockwise until the parts disengage. In the case of the revolving type, be sure to hold the barrel and rotate. Do not hold the knob.

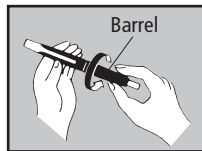

- (2) Hold the head and withdraw the penholder from the head.

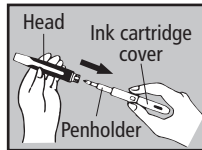

- (3) Separate the ink cartridge cover from the penholder.

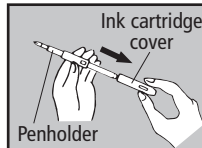

- (4) Pull out the empty cartridge while holding the pen nib upward. Insert a new ink cartridge firmly.

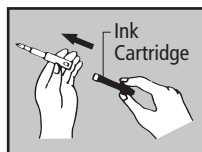

* Always hold the penholder upward to prevent ink from spilling and insert the cartridge in straight instead of rotating.

- (5) Insert the ink cartridge cover into the penholder firmly.

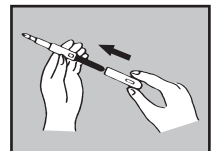

- (6) Then insert the penholder into the head by sliding the penholder's square guide knob in the guide notch in line with the pen clip.

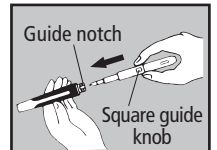

- (7) Tighten the barrel securely to the head. In the case of revolving type, be sure to hold the barrel and rotate. Do not hold the knob.

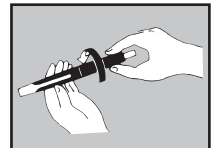

■ Converter type (separately sold)

<Rotation type Converter (CON-40)>

- (1) Keep the nib of the pen facing upward and insert the converter completely. **[Fig.1]**
- (2) Rotate the knob of the converter counterclockwise. **[Fig.2]**
(Handle the pen gently after wipe of ink in the nib with either soft tissue paper or cloth. Ink may spatter if the nib contains sufficient ink.)
- (3) As shown in Figure 3, immerse the nib into the ink vertically. **[Fig.3]**
* Be careful not to hit the bottom of the bottle with the nib point to protect the nib.
- (4) Turn the converter knob to the right to fill it with ink. **[Fig.3]**

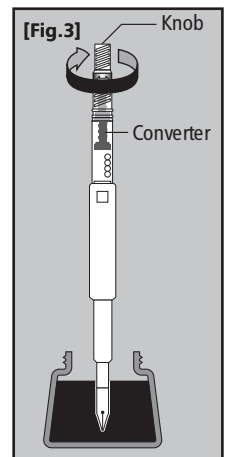
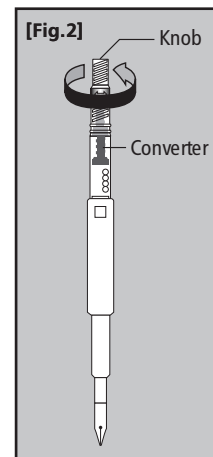
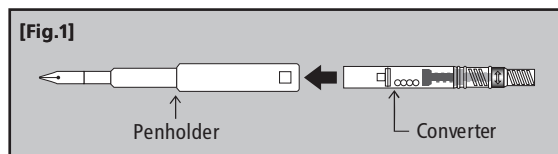

Remarks

- Please do not use this product for any purpose other than writing.
- Keep away from children.
- After use always retract the nib.
- Please use PILOT ink (cartridge or bottled) for PILOT fountain pens.
- When changing the ink
 - The lower part (A) of the penholder may occasionally become smudged with ink.
(Smudging by ink on part (A) does not affect the fountain pen's performance.)
 - Please hold the part (B) when refilling.
- Cleaning the pen
 - Over longer periods of usage, the penholder may clog with ink sediment. Wash the pen with clean water occasionally.
 - * Please refrain from washing the head and barrel. This may cause a malfunction.
- Pen tip extension and retraction
 - Gently extend and retract the pen tip. Use the retraction knob with care for extension/retraction of the nib. Rough handling of the knob causes excess flow and smudging of the ink.
- When starting to use a fountain pen for the first time, pinch the middle of the inserted cartridge with your fingers gently so that the ink flows down to the pen point.
- Prevent ink from spilling by pointing the nib upward when replacing a cartridge.
- Please avoid dropping the fountain pen or applying excessive force since the shock could cause it to malfunction.

